

## Modular Flat Channel Ventilation System

This range of Low Profile Modular Ducting Systems offer problem solving where round ducting has installation difficulties. Its low profile enables it to be concealed when installed along the top of wall units or within wall cavities. It can also be fitted in ceiling voids providing versatility whilst remaining unobtrusive.

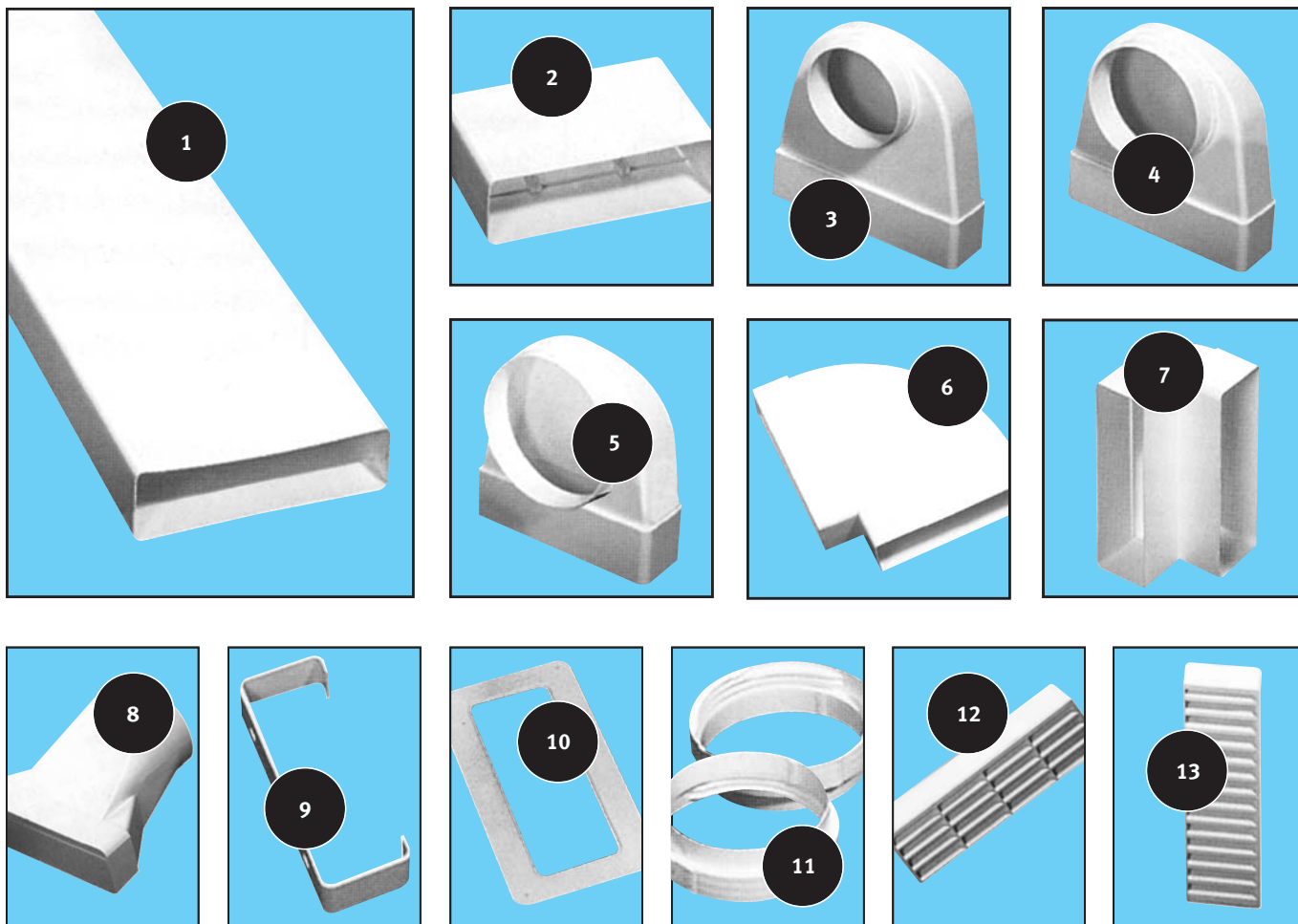

### CODES, DESCRIPTIONS & PICTURE NUMBER

SECD0519	Flat Channel 204 x 60 x 1500	1	SECD0527	Flat Channel Clip	9
SECD0520	Flat Channel Connector	2	SECD0528	Rectangular Wall Plate	10
SECD0521	Elbow Bend 100mm	3	SECD0529	Hosecon Thread 120mm (male)	11
SECD0522	Elbow Bend 125mm	4	SECD0530	Hosecon Thread 120mm (female)	11
SECD0523	Elbow Bend 150mm	5	SECD0531	Hosecon Thread 150mm (male)	11
SECD0524	Horizontal 90° Bend	6	SECD0532	Hosecon Thread 150mm (female)	11
SECD0525	Vertical 90° Bend	7	SECD0533	Horizontal Airbrick Insert	12
SECD0526	Adaptor (airbrick to 125mm)	8	SECD0534	Vertical Airbrick Insert	13