



IPX2



## CENTRIFUGAL IN-LINE FANS IN TECHNOPOLYMER

- Suitable for domestic or commercial applications.
- In-line configuration for simplified installation.
- High performances and pressure to overcome the resistance caused by long length ducting.
- Manufactured in **shock proof, high quality technopolymer, flame retarding V2.**
- Backward curved blades to ensure the lowest possible sound and to develop ample static pressure.
- Ball bearing motor, permanently lubricated for maintenance free operation and continuous running 230V-50/60 Hz.
- Motor provided with non-self-resetting thermal cut-out.
- Fan and motor assembly balanced for quiet and vibration-free operation.
- Variable speed controllable.
- Fans comply with EN 60335-2-31, EN 60335-2-80 EC Low Voltage Directive 73/23 - 93/68 and EC Directive EMC 89/336.

### SPECIFICATION

model	m <sup>3</sup> /h	Pa	W	dB(A)* @ 3m	RPM	protection	marked
AXC 100 TP	200	60	275	36,1	2700	IPX2	CE (U) E
AXC 125 TP	270	60	266	37,1	2680	IPX2	CE (U) E
AXC 150 TP	390	60	313	38,1	2500	IPX2	CE (U) E
AXC 160 TP	420	70	313	39,1	2480	IPX2	CE (U) E

\* LpA measured at 3 m from the ducted fan

### DIMENSIONS (mm)

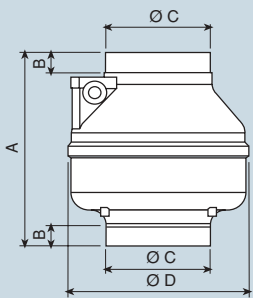

model	A	B	Ø C	Ø D	Kg.
AXC 100 TP	238	25	98	212	1,5
AXC 125 TP	238	25	123	212	1,5
AXC 150 TP	232	28	147	253	2
AXC 160 TP	232	28	157	253	2

### CURVES

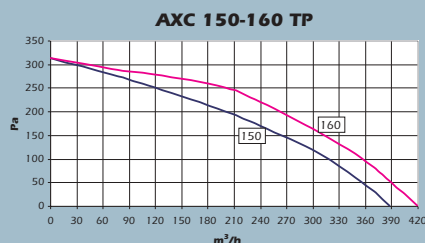
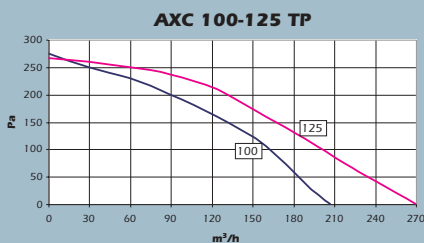

Accessories and controllers: see pages 53 - 58

# AXC TP

### APPLICATIONS

